

HEBREW SENIORLIFE – STOUGHTON DESIGN PROGRESS

STOUGHTON, MASSACHUSETTS

26 JANUARY 2024



The Power to Redefine Aging.



**DIMELLA
SHAFFER**

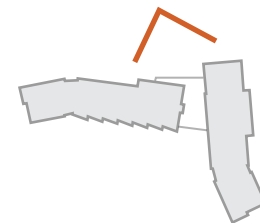

MAIN ENTRANCE DRIVE FROM CANTON STREET

HEBREW SENIORLIFE – STOUGHTON / 26 JANUARY 2024



The Power to Redefine Aging.



Hebrew
SeniorLife



HARVARD MEDICAL SCHOOL
AFFILIATE

**DIMELLA
SHAFFER**



CROWLEY
COTTRELL
LANDSCAPE ARCHITECTURE



**BEALS AND
THOMAS**

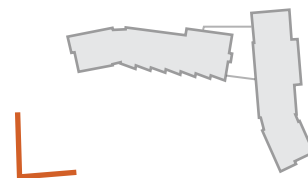

VIEW FROM THE WETLANDS TO THE WEST

HEBREW SENIORLIFE – STOUGHTON / 26 JANUARY 2024



The Power to Redefine Aging.



**DIMELLA
SHAFFER**

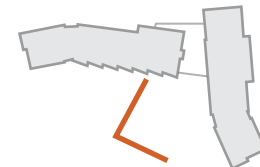

OUTSIDE COMMONS SPACE / PERGOLA
HEBREW SENIORLIFE – STOUGHTON / 26 JANUARY 2024



The Power to Redefine Aging.



**DIMELLA
SHAFFER**

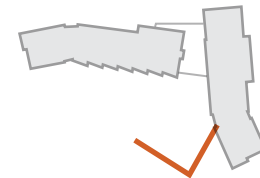

OUTSIDE COMMONS SPACE
HEBREW SENIORLIFE – STOUGHTON / 26 JANUARY 2024



The Power to Redefine Aging.



**DIMELLA
SHAFFER**

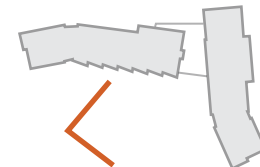

VIEW FROM THE WETLANDS TO THE WEST
HEBREW SENIORLIFE – STOUGHTON / 26 JANUARY 2024



The Power to Redefine Aging.



HARVARD MEDICAL SCHOOL
AFFILIATE

**DIMELLA
SHAFFER**

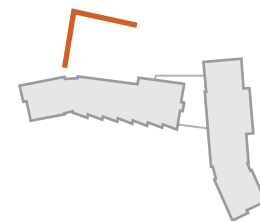

SERVICE DRIVE OFF OF CANTON STREET
HEBREW SENIORLIFE – STOUGHTON / 26 JANUARY 2024



The Power to Redefine Aging.



**DIMELLA
SHAFFER**

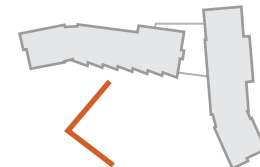

OUTSIDE COMMONS SPACE
HEBREW SENIORLIFE – STOUGHTON / 26 JANUARY 2024



The Power to Redefine Aging.



**DIMELLA
SHAFFER**

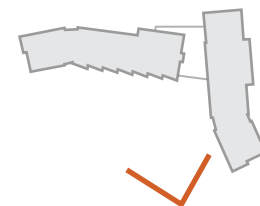

VIEW FROM THE WETLANDS TO THE SOUTH
HEBREW SENIORLIFE – STOUGHTON / 26 JANUARY 2024



The Power to Redefine Aging.



**DIMELLA
SHAFFER**

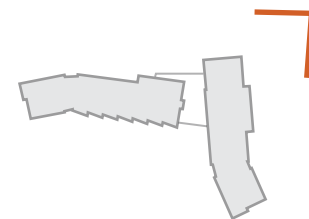

**VIEW FROM CANTON STREET /
SIMPSON STREET INTERSECTION**
HEBREW SENIORLIFE – STOUGHTON / 26 JANUARY 2024